

Hondo Nuevo Wood/Molded Wood Legs Bolt Down Tabs Assembly Instructions

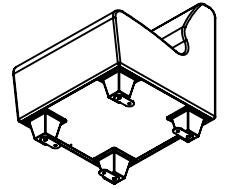

Model Number

HN800-YYY, HN860-ZZZB	HN800-YYY, HN870-ZZB
HN805L-YYY, HN860-ZZZB	HN805L-YYY, HN870-ZZB
HN805R-YYY, HN860-ZZZB	HN805R-YYY, HN870-ZZB
HN810-YYY, HN860-ZZZB	HN810-YYY, HN870-ZZB
HN815-YYY, HN860-ZZZB	HN815-YYY, HN870-ZZB
HN820-YYY, HN860-ZZZB	HN820-YYY, HN870-ZZB
HN825-YYY, HN860-ZZZB	HN825-YYY, HN870-ZZB
HN830-YYY, HN860-ZZZB	HN830-YYY, HN870-ZZB
HN835-YYY, HN860-ZZZB	HN835-YYY, HN870-ZZB
HN845-YYY, HN860-ZZZB	HN845-YYY, HN870-ZZB
HN880-YYY, HN860-ZZZB	HN880-YYY, HN870-ZZB
HN885-YYY, HN860-ZZZB	HN885-YYY, HN870-ZZB

Assembly Notes: Norix is not responsible for any damage due to improper installation. If your shipment does not match the parts list, please contact Norix Customer Service at 800-234-4900.
Norix reserves the right to modify design specifications at any time without an obligation to owners of previously sold products.

Parts List				Tools Needed
ITEM	QTY.	PART NUMBER	DESCRIPTION	Low RPM Variable Speed Drill Anchors
A	4	029-075	Plate, Bolt Down, SST	
B	4	021-091	Screw, Sheet Metal, #14X1.5", FH, Pin in Torx® T-27, Zinc	
C	4	021-077	Screw, Machine, 1/4-20 X 1", FH, Pin in Torx® T-27, Zinc	

